

To: Varsity Cross Country Coaches and Athletic Directors

From: Jered Shaw, Lawrence Free State Athletic Director
Steve Heffernan, Lawrence Free State Head Cross Country Coach

RE: 3A, 5A, and 6A Kansas State Cross Country Meet

Date of the 3A, 5A, and 6A Kansas State Cross Country Meet: Saturday, November 2nd, 2024

Cross Country Coaches and Athletic Directors:

Congratulations to you and your team for an excellent season! We understand the amount of hard work and commitment it takes to reach this level of competition and we are excited to host you at the 3A, 5A, and 6A Kansas State Cross Country meet this year! We hope your day on Rim Rock Farm is exciting and memorable. The following information provides details which will assist your day running more smoothly and ensure your student-athletes to have the best day possible.

Contact information: Jered Shaw, jered.shaw@usd497.org
Steve Heffernan, sheffern@usd497.org

Team Packets

Head coaches may pick-up their team packets at the pass gate. The packets include everything you will need for the day, including bib numbers and pins. If you need more pins, please come to the finish line/trailer area and ask for more.

Coaches Meeting

Head coaches are asked to meet ten minutes prior to the start of each race at the starting line.

Course/Map

A map of Rim Rock Farm is included at the end of this packet.

Directions

Please see enclosed handout on page

Admission

The admission price is **\$10 for k-12 and Adults Cash/Credit Card** (Please note this price is set by the KSHSAA).

Pass Gate Admittance (Please note: Family members are not included.)

- All assistant cross country coaches in our database and one team manager
- Competitors
- Superintendents, Principals, and Athletic Directors

Parking

Team buses/vans should park in the open areas next to the course grounds. All other vehicles will be directed to available lots.

Dressing/Restrooms

Dressing rooms and showers **will not be available**. Portable restrooms will be available for use at the spectator entrance and will be available for anyone to use (with runners being given the opportunity to go to the front of the line if their race is starting soon).

Scoring

Heartland Timing has been contracted by KSHSAA to score the championship races. Each competitor will receive a bib that has a timing chip as part of its design. A Finishlynx camera and an Identilyn timer video camera will be used to place runners that are very close when crossing the finish line. The determining factor for the order of finish is the torso crossing the finish line.

Since the bib will act as the chip, no chips will need to be returned. This most important thing is to make sure that your runners are wearing the bib that is assigned to them. Please check and double-check that runners are wearing the bib in which they are assigned.

Results

Coaches will be able to pick-up race results once Heartland Timing has finalized the results of each race. Hard copies of the results will be available at the trailer near the finish area – please make sure you bring your results coupons with you. Heartland Timing will post real-time results of each state race on their website as well for coaches and fans to access: [MileSplit Live Results](#). Results will also be posted at www.freestaterunning.com under the “State Cross Country tab” by Saturday evening.

Time on the Course

Times will be given at the 1-mile and 2-mile marks.

Course Markings

A lead vehicle will lead runners through the marked course.

Course Marshals

Course Marshals will be stationed around the course for the purpose of identifying any runner who might intentionally take advantage by cutting or performing any unsportsmanlike act to interfere with other runners. Any runner performing an unsportsmanlike act shall be disqualified. Please inform your runners that we have over 20 course marshals to make certain they follow the correct course.

Jury of Appeals

If you need to file a protest of the referee’s decision, please do so at the trailer so that we can resolve the situation as quickly as possible. If needed, the jury of appeals will convene to address the protest.

Chute

Workers assisting in the chute will keep runners finishing the race moving away from the finish line area. Placing is electronically determined with a Finishlynx camera and an Identilyn timer video camera used for back-up if necessary. Please instruct your athletes to continue running into the chute. Every year we have several runners stopping (and collapsing) right at the line. ****Please Note: the torso crossing the finish line is the determining factor for the order of finish.****

Uniform Rules

Coaches, please double and triple-check your runners on the uniform rules **before** the athletes run in an effort to avoid a runner being disqualified. Our chute Clerk will be checking for uniform violations as well.

Awards

For each class and gender, the Top 20 placers will be awarded medals and The Top 3 teams will receive a team plaque and team medals. Please pay attention to the award times!

Bob Timmon's Award (non-KSHSAA)

At the conclusion of the Meet, an award will be presented in recognition of Bob Timmons, long-time University of Kansas Track & Field and Cross Country Coach who is the founder and architect of Rim Rock Farm. The award will go to the individual state champion (one female winner and one male winner) with the fastest times of the day and will be presented following the awards. Please note: this award is not a part of the KSHSAA awards ceremony as the award is privately sponsored.

Awards Location

Awards will be presented at the awards stand (large rocks) East of the finish line area for presentation of the awards. Parents and fans wishing to watch the awards will cross the course during competition and need to be aware if a racer is coming through. We will not do any presenting while the race passes by the awards stand area.

Concessions

A cash only concession stand will be available for all spectators and participants.

Spectators

Parents and other fans WILL NOT be allowed near the finish line/trailer area. People working in the trailer will only field question or concerns from coaches and people other than coaches will be escorted away from the area. Coaches, please share this with your parents.

Pets & Bicycles

Pets are NOT allowed on Rim Rock Farm. Please note our gate workers will not allow anyone to enter with animals other than ones required for handicapped assistance. Spectators are also not allowed to ride bicycles on Rim Rock Farm.

Course Preservation

Please help preserve the course by picking up any trash that is around and please notify us if you see anyone damaging the course in any way. There is also a list of rules specific to Rim Rock Farm on page 11 of this packet.

2024 Kansas State Cross Country Shirts

Shirts will be available for purchase near the entrance gate. Please note: No pre-orders will be accepted.

Available Sizes

Small, Medium, Large, X-Large, XX-Large



2024 Kansas State Cross Country Participant Removal Guidelines

Safety of participants is a primary concern of the KSHSAA in all activities. There are situations when runners show signs of obvious physical distress during a race and a decision must be made about whether they should be allowed to continue or be given medical attention. Based on these concerns the KSHSAA has the following guidelines:

- A runner showing signs of obvious physical distress such as collapsing on the course, or other indications of his/her inability to finish the race may be immediately removed from the race by designated event personnel.
 - If the runner can be safely moved, the runner will be immediately transferred to the event medical area to be evaluated by onsite medical personnel.
- If a runner voluntarily removes him/herself from the race for any medical reason or is removed by their coach, they should also proceed to the medical area for evaluation. The onsite medical personnel will determine the appropriate care to be administered.

To assist designated event personnel and coaches on determining the level of distress, these guidelines will be used:

- If the runner looks questionable, event personnel will ask if they need help, if the runner is able to answer immediately and clearly state "no" the runner will be allowed to continue. If a runner looks questionable and event personnel asks if they need help and the answer is "yes" the runner will be pulled.
- If the runner looks questionable and event personnel ask "if they need help" and there is no response, the event personnel will continue to follow the runner (off the course) and monitor.
- If the runner continues to be unresponsive to the event personnel and is unable to run fast enough to separate themselves from the walking event personnel, the runner will be pulled.
- If the runner is able to communicate something and they are just tired, they will be allowed to continue. Course Marshals designated by meet management will be provided these guidelines.

Water will not be provided by meet management on the course during the race. Water will be available before and after the race. A determination on whether or not coaches will be allowed to hand out water during a race will be made prior to the start of races each day. Please note: the challenge of handing water to runners is the potential to interfere with other runners when handing the water and what the runner will do with the bottle/cup that could possibly interfere with another runner. In a 5K race, runners who are properly hydrated before the race begins have little risk of becoming dehydrated during the race.

Towels will not be allowed to be handed out on the course, and they may only be distributed by team personnel after the runner has cleared the finish chute.

Cold water immersion tanks will be available if the weather dictates. Meet management will determine the need based on the Heat Guidelines provided.

I

There will be medical personnel and an ambulance will be on site. A trail vehicle will be provided to transport runners in distress to the medical area. A runner who is in need of medical attention shall not be removed from the medical area until cleared by the personnel on site. Coaches/parents should not take a runner away from this area until cleared.

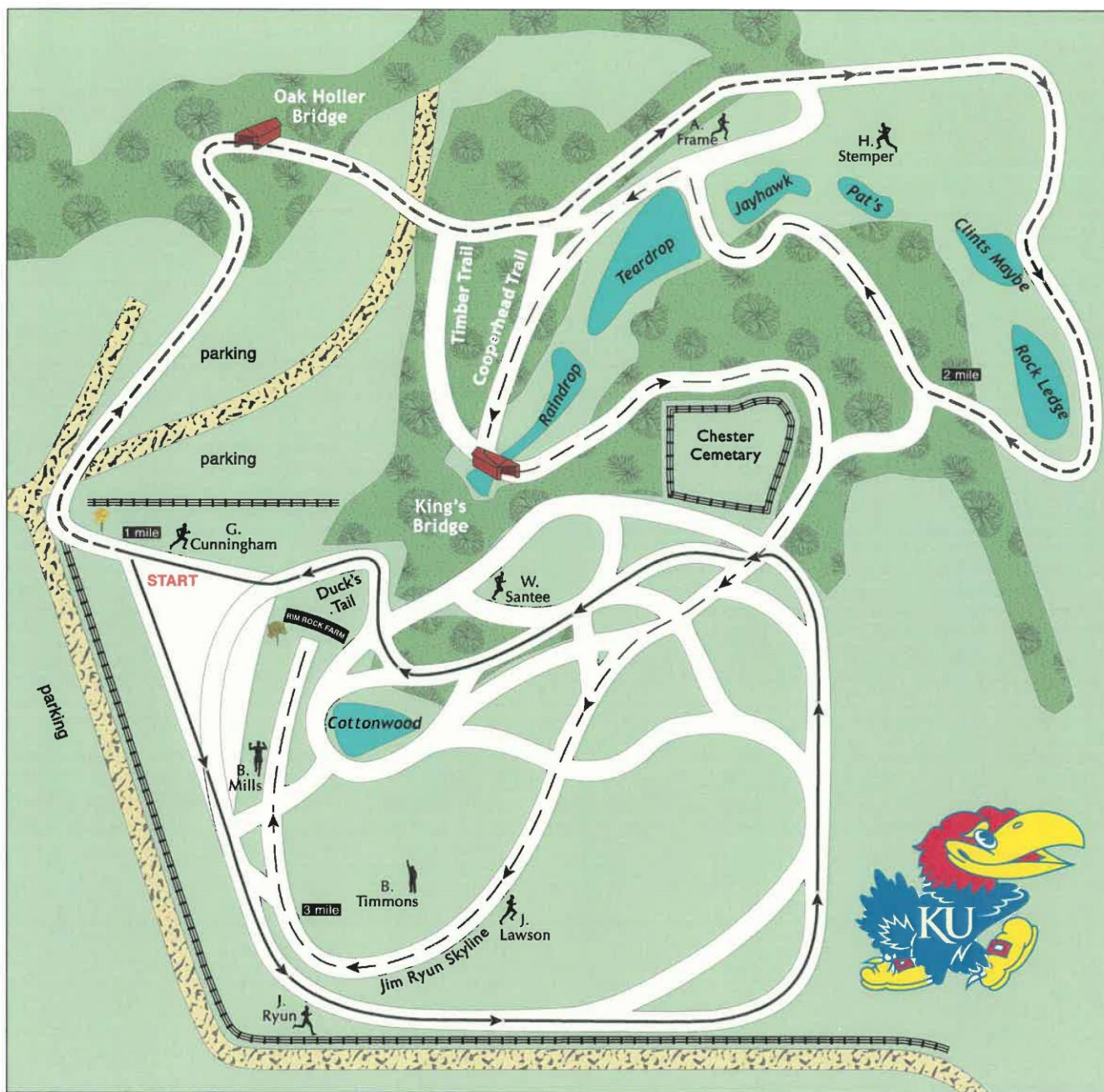

Competition Routes			
—————	1st Mile	=====	Fence
- - - - -	2nd Mile		Road
- . - . -	3rd Mile	■	Trees
		■	Grass
		—	Trail

5K COURSE

RIM ROCK FARM

THE UNIVERSITY OF KANSAS

RIM ROCK FARM

RIM ROCK FARM ADDRESS:

2276 Burnett Lane
Lawrence, KS 66044

1. Start by going NORTH on KS Highway 24/59
(2.8 miles from Turnpike exit 204,
4.1 miles from the bridge)
2. Turn RIGHT onto E 1400 Rd / CR-1045
(0.9 miles)
3. E 1400 Rd / CR-1045 becomes 1045
(1.6 miles)
4. Turn LEFT onto 13th
(0.3 miles)
5. Turn RIGHT on Republic Rd
(0.5 miles)
6. Republic Rd becomes Republic St
(0.6 miles)
7. Turn RIGHT onto Burnett Lane
(0.1 miles)

